

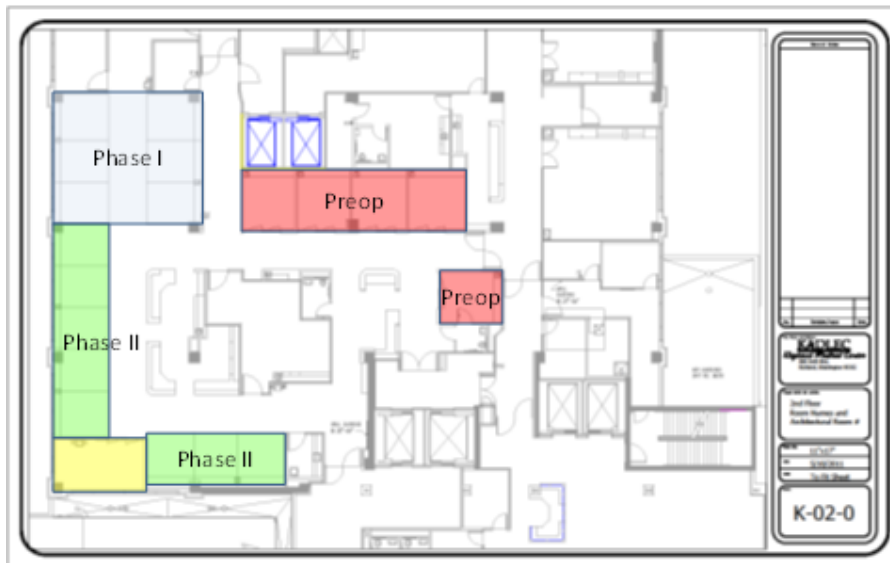

Origination: 10/2011
 Last Approved: 10/2017
 Last Revised: 10/2017
 Next Review: 10/2020
 Owner: Tracy Hasty: Manager, Unit
 Policy Area: PACU
 References:

Pre-Op Patient Flow, 49.02.00

SPACE ASSIGNMENT:



- Pre-Surgery Bays 1 thru 12.
- Phase I Bays 12 thru 20.
- Phase II Bays 6-14.
- Bay 9: Use for Pediatric Recovery Phase I primary and Phase II secondary and patients with special needs.
- Nights and Weekends: Pre-Surgery Bays 1 thru 5, Phase I and II in Bays 8– 20.

ATTACHMENTS:

- Pre-Op Standard Flow
- Pre-Op Inpatient Flow
- Pre-Op Same Day Unplanned Flow
- Pre-Op Heart Case Flow
- Pre-Op Knee and Hip Flow

Attachments:



Image 01

Process Flow Worksheet – Pre-Op – Heart

Case Flow
Process Flow Worksheet – Pre-Op –
Inpatient Flow
Process Flow Worksheet – Pre-Op – Knee
& Hip
Process Flow Worksheet – Pre-Op – Same
Day Unplanned Flow
Process Flow Worksheet – Pre-Op –
Standard Flow

Approval Signatures

Approver	Date
Kirk Harper: VP, Nursing & CNO	10/2017
Crystal Wise: Administrative Assistant	10/2017
Tracy Hasty: Manager, Unit	10/2017

Applicability

Kadlec Regional Medical Center

COPY